

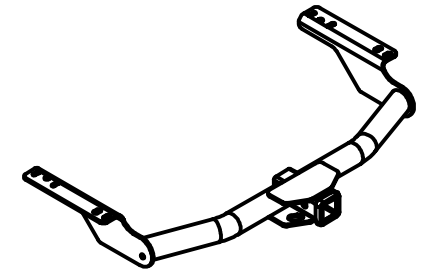

Class III Receiver Hitch

Part No. 69577C



Fits: LEXUS GX470 & TOYOTA 4-RUNNER



GROSS LOAD CAPACITY WHEN USED AS A WEIGHT CARRYING HITCH: 5,000 LBS. TRAILER WEIGHT & 500 LBS. TONGUE WEIGHT.
GROSS LOAD CAPACITY WHEN USED AS A WEIGHT DISTRIBUTION HITCH: 5,500 LBS. TRAILER WEIGHT & 550 LBS. TONGUE WEIGHT



WARNING: * DO NOT EXCEED VEHICLE MANUFACTURER'S RECOMMENDED TOWING CAPACITY. *****

Parts List			
ITEM	QTY	PART NUMBER	DESCRIPTION
1	4	1/2"	CONICAL TOOTHED WASHER
2	4	M12 - 1.25 x 40 HEX	HEX TAP BOLT
3	4	3/8"	CONICAL TOOTHED WASHER
4	4	M8-1.25 x 35	HEX TAP BOLT

RUBBER ISOLATOR REMOVAL DIAGRAM

This technique can be used if and Exhaust Hanger Removal Pliers is not available.

Using a 5/8" open end wrench, slide the wrench up to the rubber isolator, cradling the hanger rod as shown. Next place the flat edge of a pry bar between the wrench and the hanger stop or hanger rod. Then simply rotate the pry bar toward the wrench to remove the rubber isolator.

Note: Using a spray lubricant or soapy water on the hanger rod and the rubber isolator helps removal.

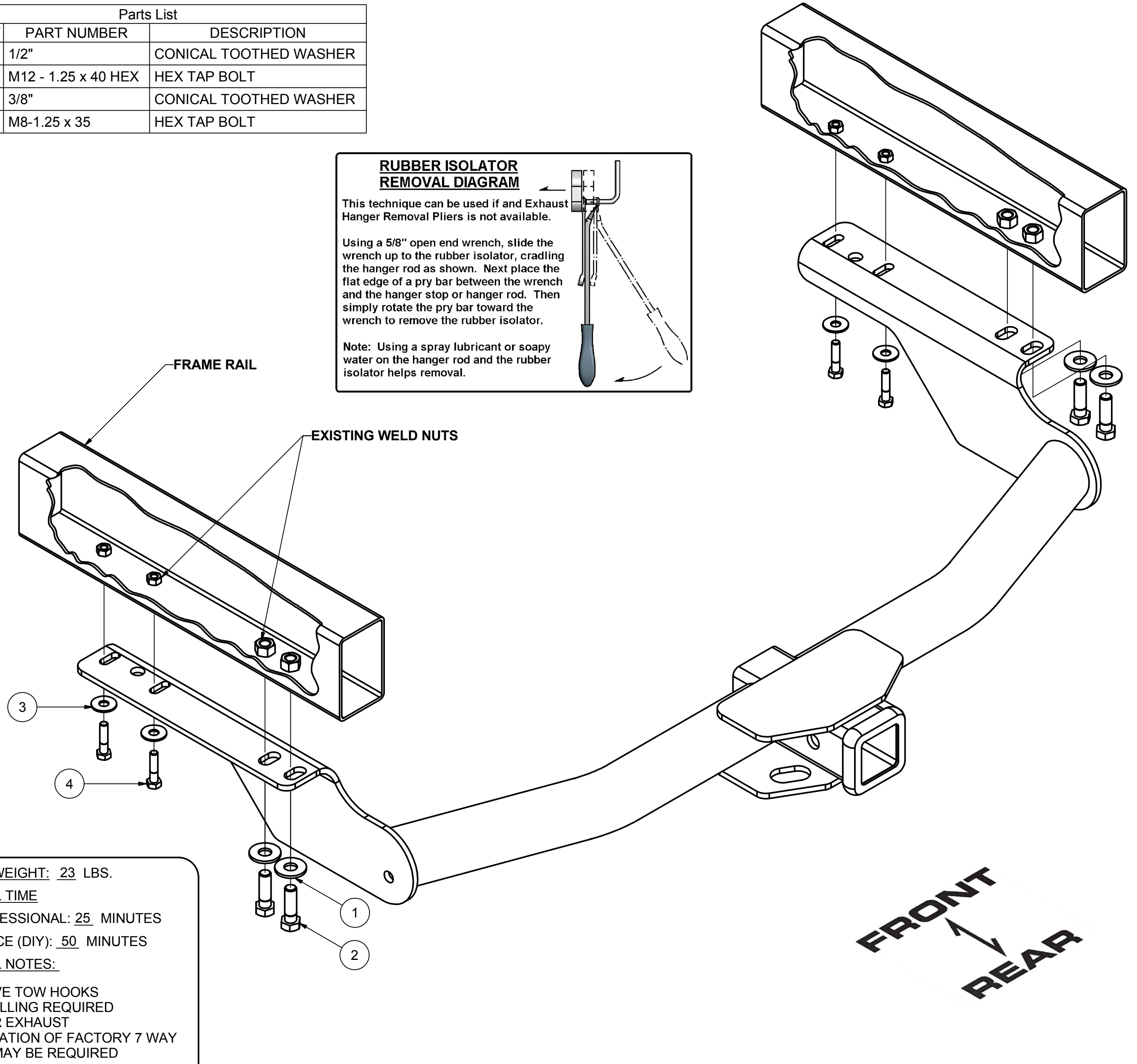

HITCH WEIGHT: 23 LBS.
INSTALL TIME
PROFESSIONAL: 25 MINUTES
NOVICE (DIY): 50 MINUTES
INSTALL NOTES:
-REMOVE TOW HOOKS
-NO DRILLING REQUIRED
-LOWER EXHAUST
-RELOCATION OF FACTORY 7 WAY PLUG MAY BE REQUIRED

- ### INSTALLATION STEPS
1. Remove tow hooks if present.
 2. Maneuver passenger side plate over the exhaust and hold hitch up against frame.
 3. Line up holes in the hitch side plates to existing weldnuts in frame. Install M12 and M8 bolts as shown.
 4. Torque all M12 fasteners to 86 ft.-lbs. Torque all M8 fasteners to 23 ft.-lbs.
- PERIODICALLY CHECK THIS RECEIVER HITCH TO ENSURE THAT ALL FASTENERS ARE TIGHT AND THAT ALL STRUCTURAL COMPONENTS ARE SOUND.**

Keystone Automotive Operations Inc., warrants this product to be free of defects in material and/or workmanship at the time of retail purchase by the original purchaser. If the product is found to be defective, Keystone Automotive Operations Inc., may repair or replace the product, at their option, when the product is returned, prepaid, with proof of purchase. Alteration to, misuse of, or improper installation of this product voids the warranty. Keystone Automotive Operations Inc.'s liability is limited to repair or replacement of products found to be defective, and specifically excludes liability for incidental or consequential loss or damage. This product complies with safety specifications and requirements for connecting devices and towing systems of the state of New York, V.E.S.C. Regulation V-5 and SAE J684. For Technical & Warranty Support: 1-877-544-4449 Fax- 1-855-242-8922 www.huskytow.com **11202017**